

## static seal R20-SA

## seal spec

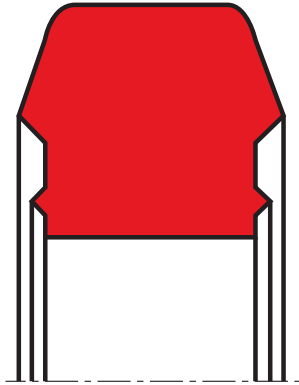

### description

static seal made of a profiled ring with two cutting edge-shaped sealing edges on the front faces.

### application



### category of profile

machined or molded/standard/trade product.

### advantages

- good stress distribution due to the position of the sealing edge in the groove
- secure seating in the housing for extremely high, pulsating pressure peaks
- made of extrusion-resistant polyurethane material

### application

hydraulic control and regulation equipment, hydraulic hammers.

### operating parameters & materials

diameter range: up to 600 mm

material	temperature	max. pressure
s-mart PU 95 Shore A	-30 °C ... +110 °C	800 bar (80 MPa)

*the stated operation conditions represent general indications. it is recommended not to use all maximum values simultaneously.  
surface speed limits apply only to the presence of adequate lubrication film.*

### surface quality

surface roughness	Rtmax (µm)	Ra (µm)
bottom of groove	≤6,3	≤1,8
groove face	≤16	≤3



**seal & housing recommendations**

*please note that we are able to produce those profiles to your specific need or any non standard housing. for detail measurements, please see seal-mart catalog...*

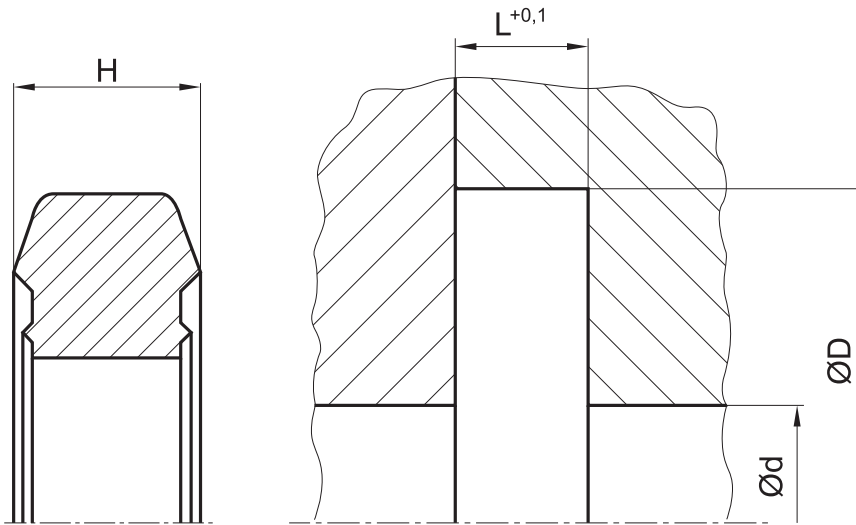

*don't hesitate to contact our technical department for further information or for special requirements (temperature, speed etc.), so that suitable materials and/or designs can be recommended.*